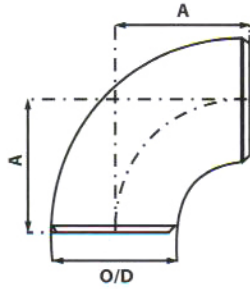
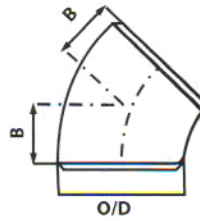
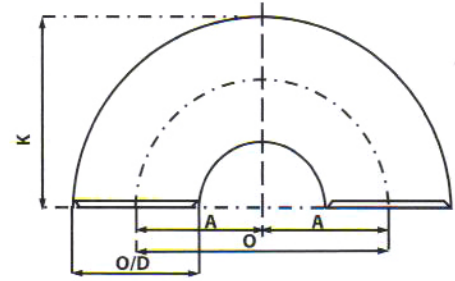

LR ELBOW & LR RETURN / U BEND

90° LR ELBOW

45° LR ELBOW

180° LR RETURN / U BEND

B16.9

Nominal Pipe Size (NPS)	Outside Diameter at Bevel (O/D)	Dimension A	Dimension B	Center to Center O	Back to Face K
1/2"	21.3	38	16	76	48
3/4"	26.7	38	19	76	51
1"	33.4	38	22	76	56
1.1/4"	42.2	48	25	95	70
1.1/2"	48.3	57	29	114	83
2"	60.3	76	35	152	106
2.1/2"	73.0	95	44	190	132
3"	88.9	114	51	229	159
3.1/2"	101.6	133	57	267	184
4"	114.3	152	64	305	210
5"	141.3	190	79	381	262
6"	168.3	229	95	457	313
8"	219.1	305	127	610	414
10"	273.0	381	159	762	518
12"	323.8	457	190	914	619
14"	355.6	533	222	1067	711
16"	406.4	610	254	1219	813
18"	457.0	686	286	1372	914
20"	508.0	762	318	1524	1016
22"	559.0	838	343	1676	1118
24"	610.0	914	381	1829	1219
26"	660.0	991	406
28"	711.0	1067	438
30"	762.0	1143	470
32"	813.0	1219	502
34"	864.0	1295	533
36"	914.0	1372	565

Note : All Dimensions are in millimeters (mm)
 Dimension for 40" and above on request.