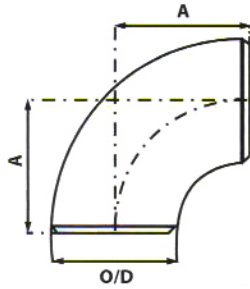
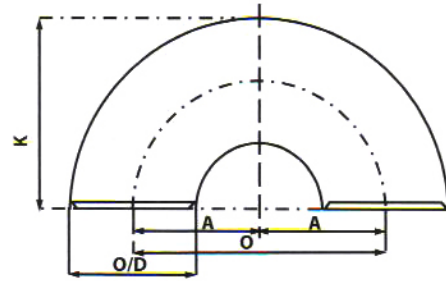

SR ELBOW & SR RETURN BEND

90° SR ELBOW

45° SR ELBOW

180° SR RETURN BEND

B16.9 / B16.28

Nominal Pipe Size (NPS)	Outside Diameter at Bevel (O/D)	Dimension A	Dimension B	Center to Center O	Back to Face K
1/2"	21.3
3/4"	26.7
1"	33.4	25	51	41
1.1/4"	42.2	32	64	52
1.1/2"	48.3	38	76	62
2"	60.3	51	...	102	81
2.1/2"	73.0	64	127	100
3"	88.9	76	31.6	152	121
3.1/2"	101.6	89	36.8	178	140
4"	114.3	102	42.1	203	159
5"	141.3	127	52.6	254	197
6"	168.3	152	63.4	305	237
8"	219.1	203	84.2	406	313
10"	273.0	254	105.2	508	391
12"	323.8	305	126.3	610	467
14"	355.6	356	147.3	711	533
16"	406.4	406	168.3	813	610
18"	457.0	457	189.4	914	686
20"	508.0	508	210.4	1016	762
22"	559.0	559	231.5	1118	838
24"	610.0	610	252.5	1219	914

Note : All Dimensions are in millimeters (mm)